

LOMBARD AVE

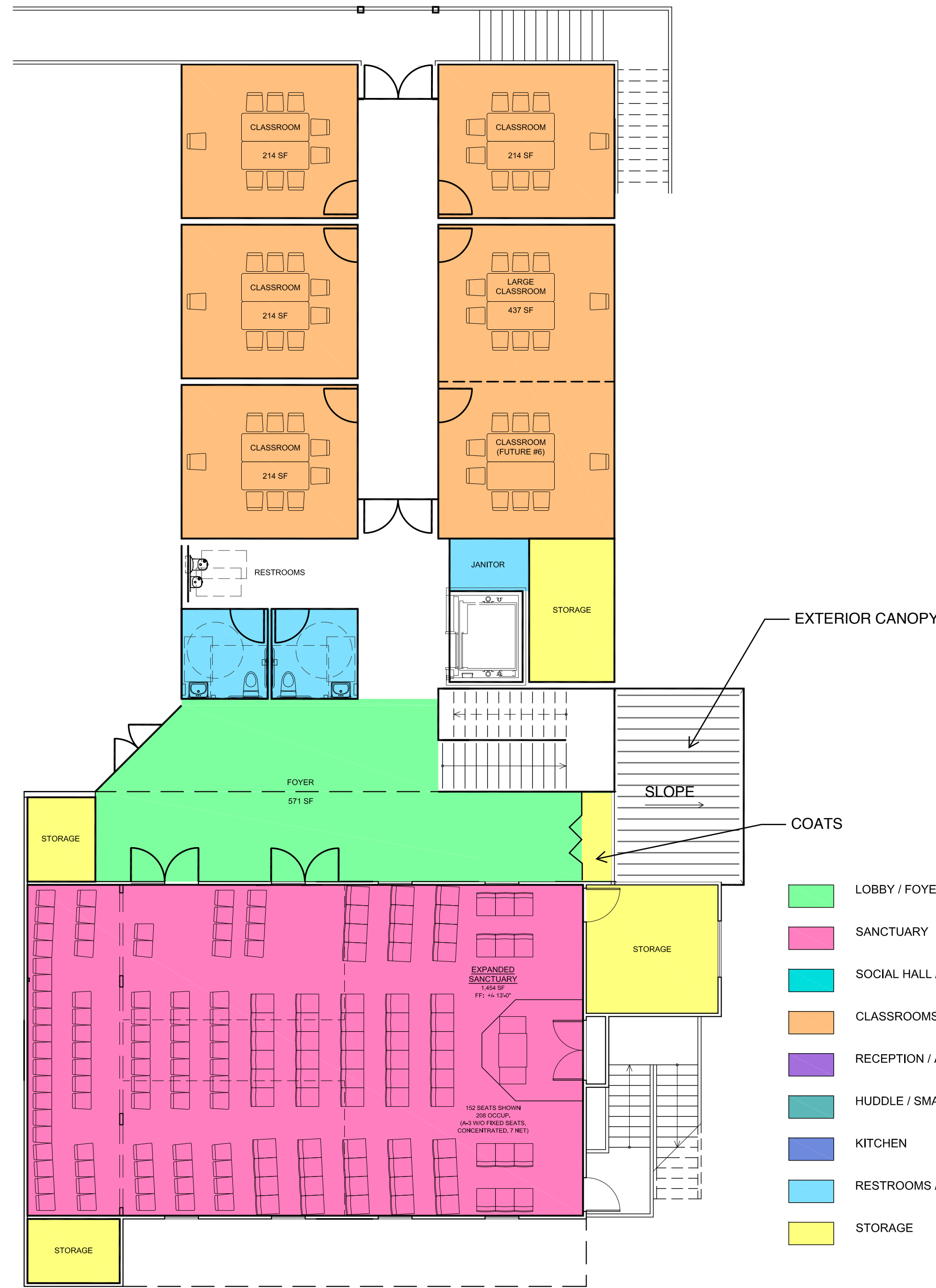

- LOBBY / FOYER
- SANCTUARY
- SOCIAL HALL / ONEG
- CLASSROOMS
- RECEPTION / ADMINISTRATION OFFICES
- HUDDLE / SMALL MEETING / LIBRARY
- KITCHEN
- RESTROOMS / JANITOR
- STORAGE

NORTH
 TEMPLE BETH OR MASTER PLAN
 CONCEPTUAL UPPER FLOOR PLAN
 05/19/2021
 SCALE: 1/8" = 1'-0"
 +/- 2,904 SF ADDITION (EXCLUDES OPEN TO BELOW)

DESIGNS
 north west
 ARCHITECTS
 Tel: 360.629.3441 Fax: 360.629.6159
 P.O. Box 1270 Starwood, WA 98292

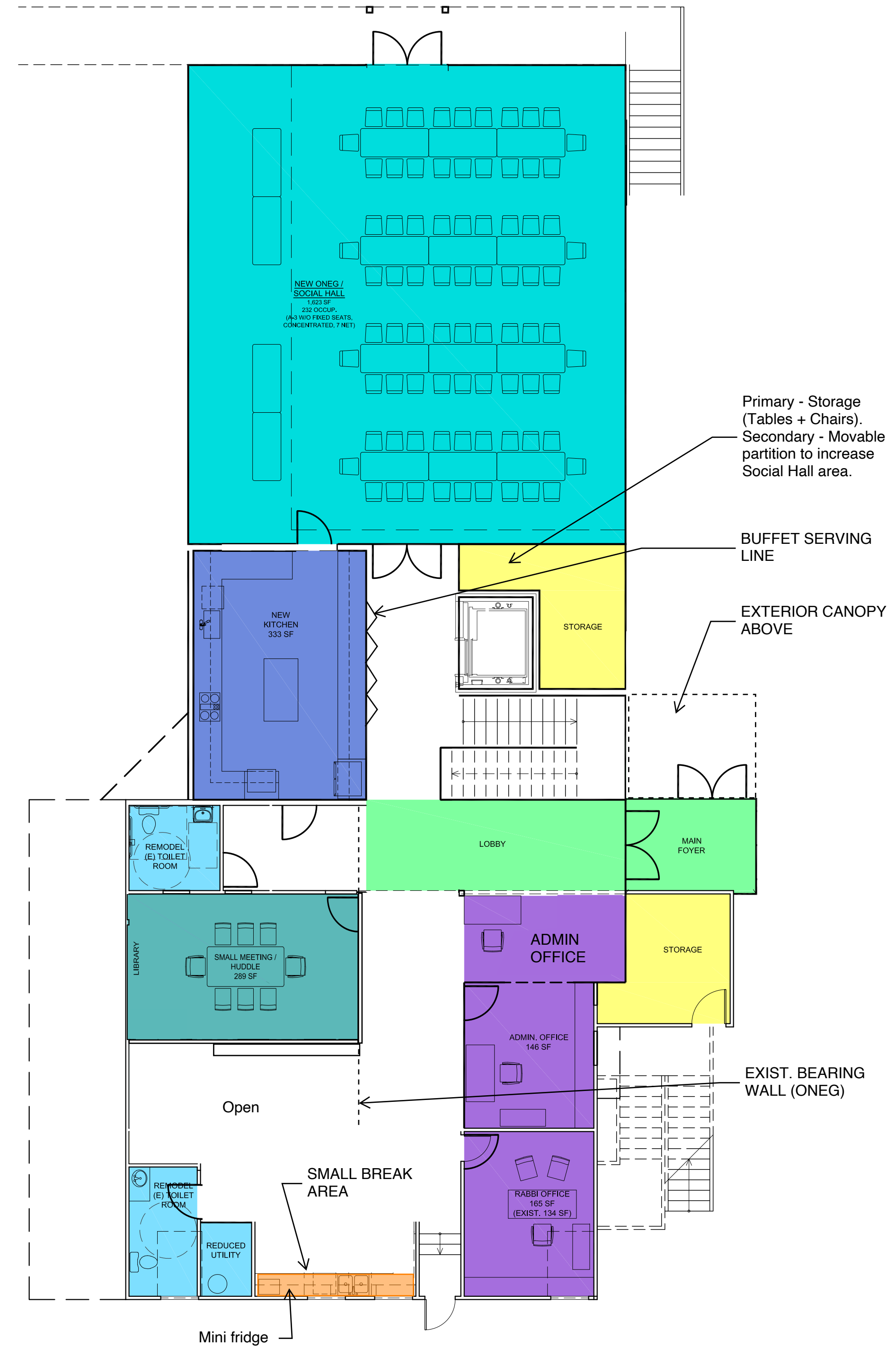

NORTH
 TEMPLE BETH OR MASTER PLAN
 CONCEPTUAL MAIN FLOOR PLAN
 05/19/2021
 SCALE: 1/8" = 1'-0"
 +/- 3,015 SF ADDITION

DESIGNS
 north west
 ARCHITECTS
 Tel: 360.629.3441 Fax: 360.629.6159
 P.O. Box 1270 Starwood, WA 98292

D: Facilities Planning Task Force Draft of Floor Plan Drawing – Paul Vexler

Draft Print For Review
 05/31/2021 4:44:42 PM 05/31/2021 4:44:48 PM

REVISIONS:

DESIGNS
 north west
 ARCHITECTS
 10031 SR 532, SUITE B
 STARWOOD, WA 98292
 PH: 360.629.3441
 FX: 360.629.6159
 info@designsnw.com
 www.designsnw.com
 © Copyright 2021 DNWA, Inc. - Property of DNWA, Inc. & is an instrument of service.

TEMPLE BETH OR
 MASTER PLAN & CONCEPTUAL DESIGN
 3215 Lombard Ave., Everett WA 98201
 APN 00439076300700 (& -300, -400, -900)

CONCEPTUAL
 FLOOR PLANS

DATE: 05/19/2021
 DESIGNED: DN / KW
 DRAWN: KW
 JOB NO: 2021-26
 SHEET:

A-2.1